



ORIGINAL FLINT KINDLING SPLITTER

INSTRUCTIONS FOR USE



SELECTING A LOCATION

Ideally, select a sheltered location that allows you to comfortably use your Flint-kindling splitter every day, e.g. in a wood shed, on the terrace, or directly next to the fireplace in your living room.

INSTRUCTIONS

Fibrous woods like spruce, fir, birch, or ash are best suited for splitting. Tip: When acquiring new pieces of wood, take a few branchless pieces of wood and set them aside. That way you always have suitable wood for chippings!

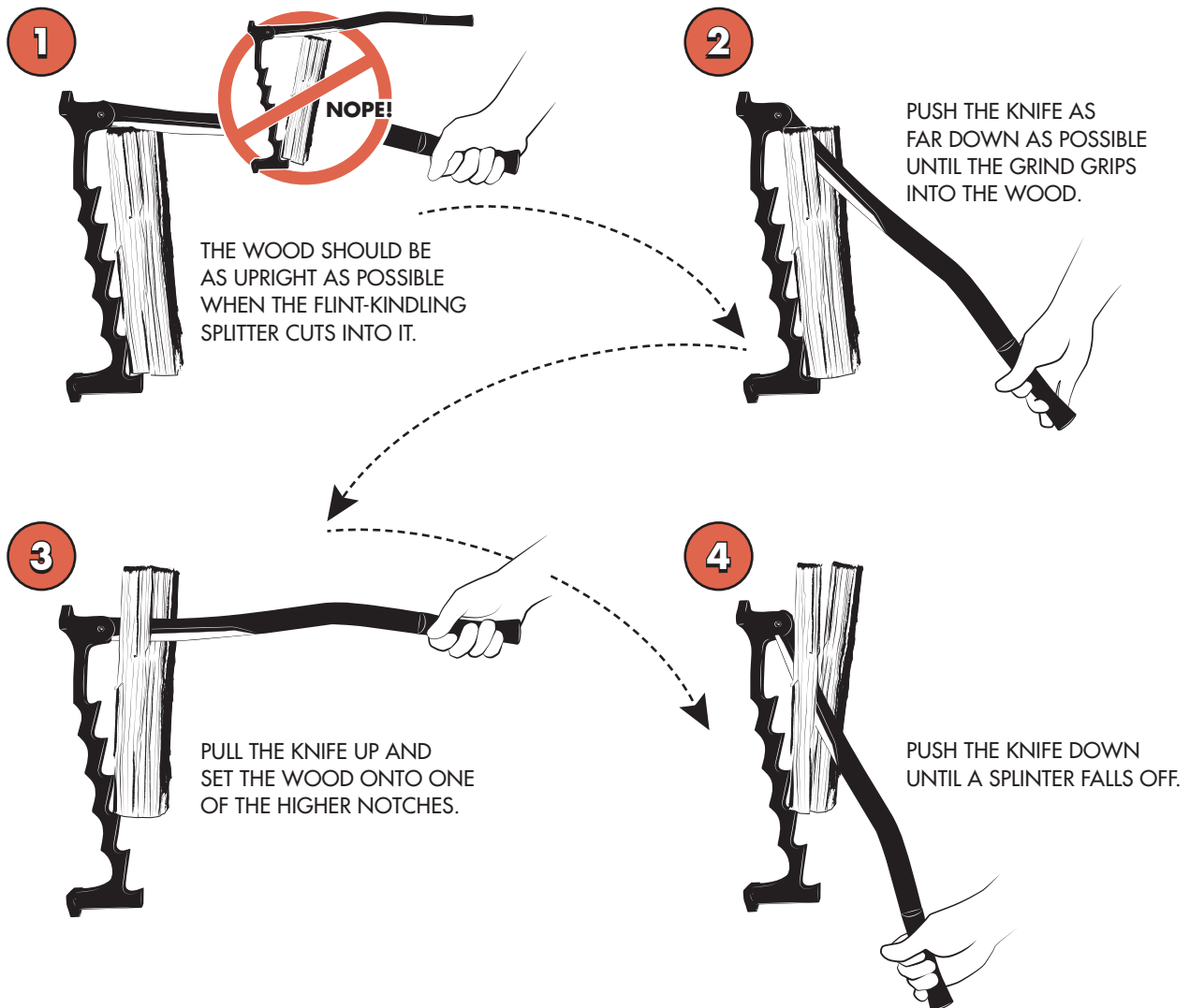

MAINTENANCE OF THE FLINT-KINDLING SPLITTER

- Occasionally grease the turning joint of the Flint-kindling splitter with a few drops of mechanical oil.
- Regularly check that the screws are firmly positioned. If they have loosened, also check the fastening points in the wall and fix them if necessary.
- In case of rust, the entire Flint-kindling splitter can be rubbed down with flaxseed oil.



ORIGINAL FLINT KINDLING SPLITTER

ASSEMBLY INSTRUCTIONS



ASSEMBLY INSTRUCTIONS

The wall on which the Flint-kindling splitter will be mounted must be made from a stable material. For example, a brick or concrete wall or a wooden beam are suitable. Please note: drywall surfaces or wood panel walls, as well as walls made from Ytong blocks, are not suitable.

- First make sure that no water or power lines run through the drilling area.
- Lay the drilling template on a flat undersurface.
- Place the Flint-kindling splitter on the drilling template, aligning it with the upper contour and lateral lines. ①
- Use a sharp pencil to mark the four drill holes on the Flint-kindling splitter onto the template.

INCLUDED IN THE PACKAGING

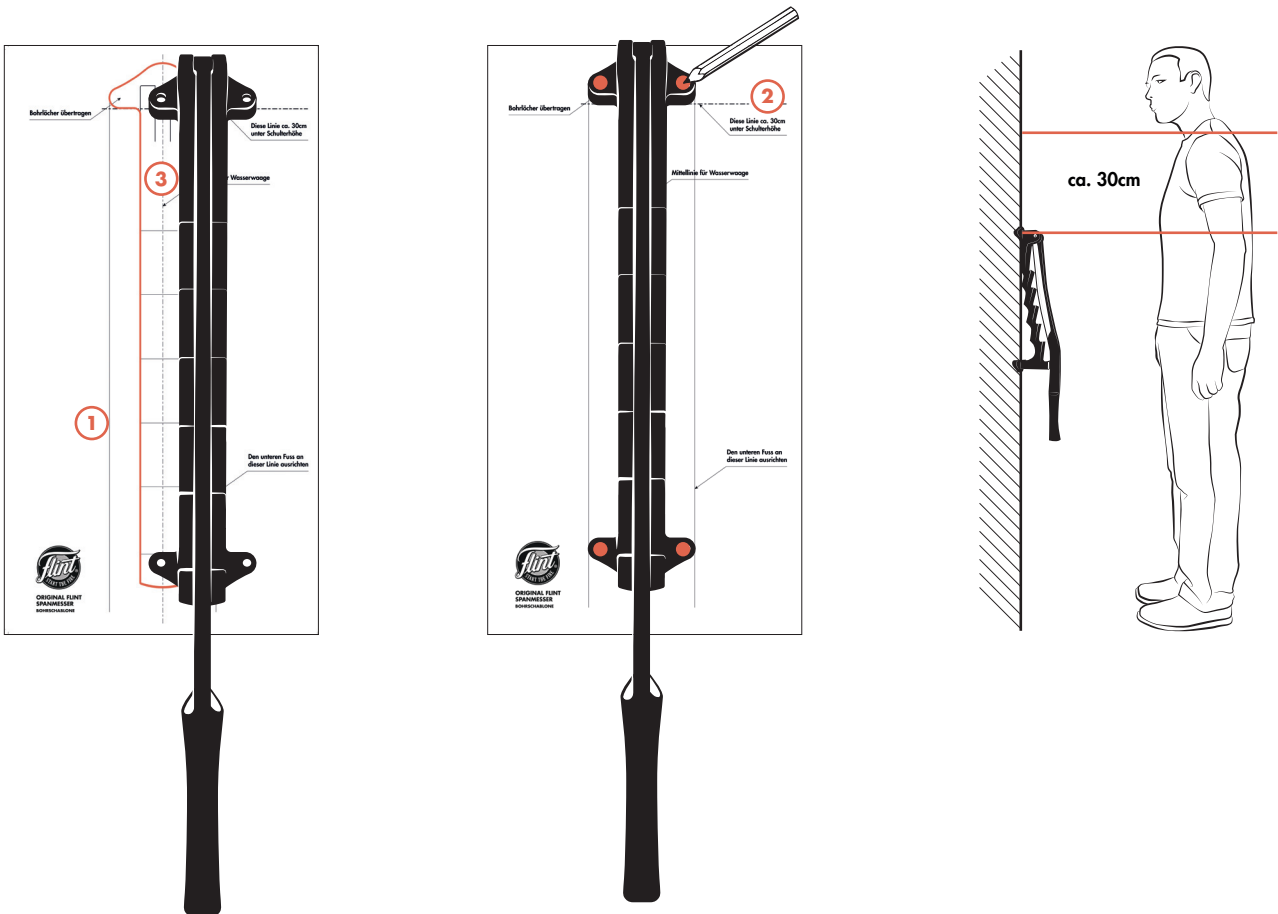
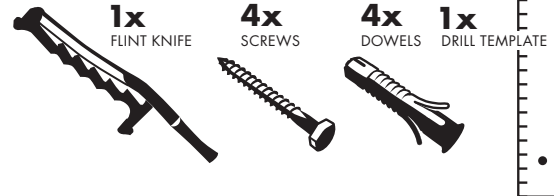

- Set the assembly height of the Flint-kindling splitter as follows: Line ② on the drilling template should be about 30 cm below your shoulder height.
- Use an adhesive strip to fasten the drilling template to the set position.
- Vertically align the drilling template over line ③ with a level.
- Use the template to mark the four fastening points onto the wall.
- Now drill the fastening holes.
- 8mm stone drill for masonry with dowel assembly.
- 4mm drill for wood.
- After cleaning the drill holes, you can fasten the Flint-kindling splitter with the screws / dowels provided.

OTHER LANGUAGES

